

C.C. Leclerc

Projet de Division

ECHELLE: 1/500

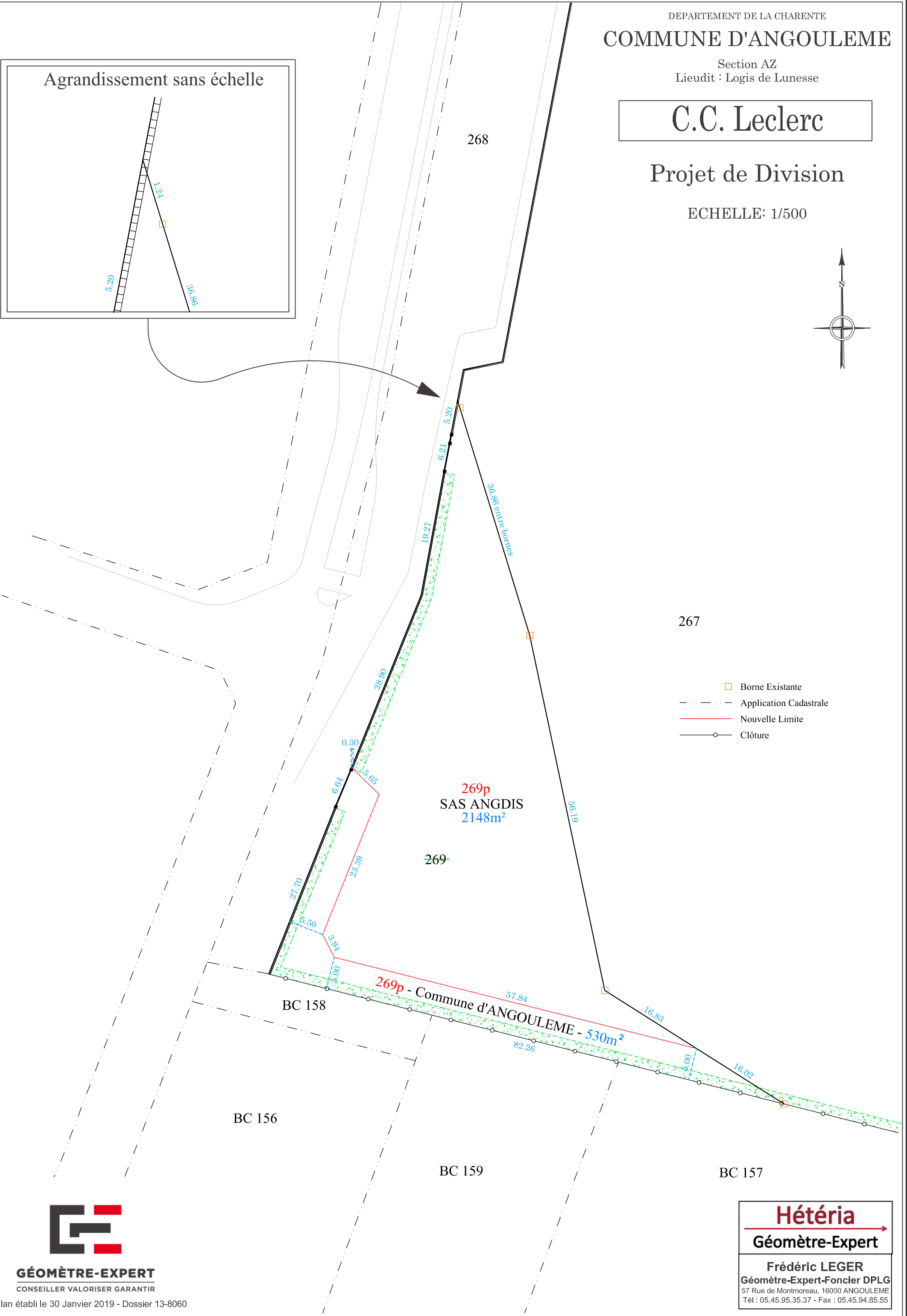
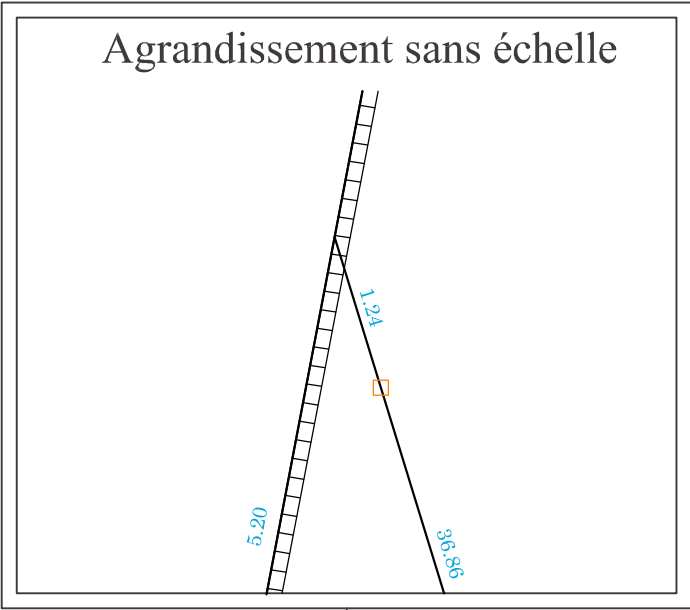
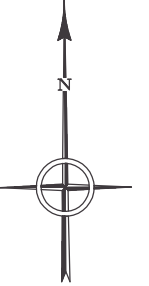

267

268

269

269p
SAS ANGDIS
2148m²





269p - Commune d'ANGOULEME - 530m²

BC 158

BC 156

BC 159

BC 157

-  Borne Existante
-  Application Cadastreale
-  Nouvelle Limite
-  Clôture



GÉOMÈTRE-EXPERT
CONSEILLER VALORISER GARANTIR

Plan établi le 30 Janvier 2019 - Dossier 13-8060

Hétéria
Géomètre-Expert

Frédéric LEGER
Géomètre-Expert-Foncier DPLG
57 Rue de Montmoreau, 16000 ANGOULEME
Tél : 05.45.95.35.37 - Fax : 05.45.94.85.55